

FLETA ZX

FLETA ZX USER MANUAL

Thank you for purchasing FLETA ZX motor series.
 FLETA ZX series is based technology of the Muchmore Racing R&D team.
 World champion driver Marc Rheinard participating in the test.
 Developed for the driver can optimize their controllability of handling.
 1/10 Touring Car and Off-Road, provides the best performance for all categories.

FEATURES

- FLOW-MAX™ Body Design
- Strong Aluminum Mounting Sensor
- ZX Balance Rotor
- Easy-To-Timing System
- Low-Friction Ball Bearing
- Approve World Race Regulations

SPECIFICATIONS

Diameter : 35.8mm
 Length : 53.2mm
 Weight : 171 ~ 177g
 Cells : 3.7V ~ 7.4V
 Winding : STAR

Installation and Connections

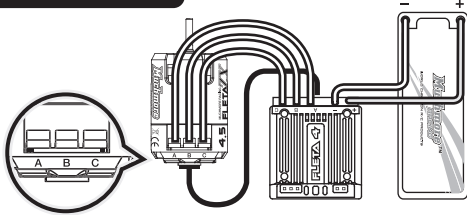

- Install the sensor wire exactly. If any connection comes wrong, it can occurred no-control situation. Sensor wire is very thin, do not contact in every motor mount, carbon parts, etc.
- Install the motor in the motor mount with screw.
 Caution: The length of screw shall not exceed 8mm, it causes a defect of inside state.
- Make sure the polarity of ESC and motor, connect the power wires of the ESC and the motor.
 - By checking the color code and the letter, soldering each wire.
 [A]= BLUE, [B]= YELLOW, [C]= ORANGE
- Make sure all the connections before using the motor.
- Checking the operation of motor.

Maintenance

- Unscrew the motor housing and remove each part carefully.
- Pull all the parts, clean them using brush and R/C cleaner. After cleaning let them dry enough.
- Apply Muchmore racing bearing oil to front/back bearing. (CHE-SB Spin Lube for Bearings)
- Re-assemble carefully, in reverse order as below disassembly images.
 Be careful with correct shim/o-ring position during re-assembly and avoid over tightening the screws, if not it can damage your motor sensor.
- Using Muchmore racing exclusive tool, replace the motor bearing. (MK-BRP3 Brushless Motor Bearing Puller er.3)

Disassembly

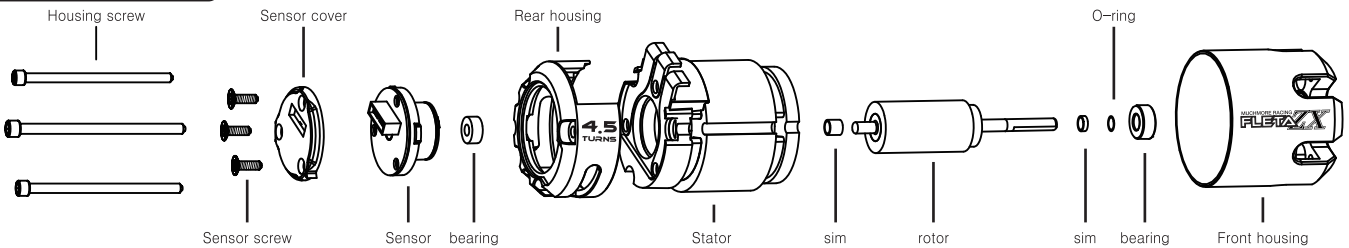

Gearing Chart

- Gearing ratio chart is only for reference.
 - The actual gearing may vary due to different track width, motor timing, track condition, ESC setting, etc.
 - Gearing ratio calculation methods: (Pinion gear T / Spur gear T x Reduction ratio = * -> 1 : *)
 (Reduction ratio is recommended from kit manual, or check the each manufacturer)
 - Using on drift kit, throttle of driver and grip of tire make a big difference.
- Start Touring Car (small track) gear ratio, check the motor temperature after 1minute driving later and 3 minutes, 5 minutes.

Adjust gear ratio avoid exceed 70°C motor temperature. If motor is high temperature, adjust gear ratio higher than before.

- * 1/12 Racing in the index notation. (Tire diameter × 3.14 ÷ (Pinion gear T) ÷ Spur gear T)
- * Pay attention to motor temperature at the gearing settings.
 Maximum working temperature is 80°C (175F), should never exceed 80°C (175F).
- * Be careful because it can cause damages to your motor.
- * Shall not be held any responsible for information and advice non-compliance results.

Category	Voltage	21.5T	17.5T	13.5T	10.5T	8.5T	8.0T	7.5T	7.0T	6.5T	5.5T	5.0T	4.5T	4.0T	3.5T
TC(small track)	2S/7.4	1:5.0	1:5.5	1:7.0	1:7.5	-	-	-	-	1:7.8	1:8.0	1:8.3	1:8.7	1:9.2	1:9.5
TC(big track)	2S/7.4	1:4.5	1:5.0	1:6.5	1:7.	-	-	-	-	1:7.5	1:7.8	1:8.0	1:8.3	1:8.8	1:9.0
2WD Off-road	2S/7.4	-	-	-	1:6.5	1:8.5	1:9.0	1:9.5	1:10.0	1:10.5	-	-	-	-	-
2WD SC	2S/7.4	-	-	-	1:8.0	1:10.0	1:10.5	1:11.0	1:11.5	1:12.0	-	-	-	-	-
4WD Off-road	2S/7.4	-	-	-	-	1:9.0	1:9.5	1:10.0	1:10.5	1:11.0	1:12.0	-	-	-	-
1/12 Racing	1S/3.7	-	-	-	-	-	-	-	-	-	38mm	36mm	34mm	32mm	31mm

Warranty

Parts for defects and flaws of this product, please ask your dealer or distributor you purchased along with the receipt within 120 days from the date of original purchase.
 The maximum amount of the above warranty, failure or defect normal wear and tear, incorrect use, due to improper repair or modification can not be guaranteed. This also applies to matters such as the following.

- If you are connected in reverse polarity of the product
- physical damage case
- physical damage of the electronic component and the circuit board
- (except soldering external) of the circuit board soldering
- Before the product for warranty service, please check how to resolve the problem before and all component parts.
- To obtain warranty service the product, you will need the receipt of the products you have purchased.
 (If you do not have a receipt, the warranty period not permitted.)
- Please fill in the address and contact details of the defect and the defect or repair or for faster delivery.

- product repair
- If the repair of the product, you will need a receipt at the time of purchase.
- For repair damaged parts, the cost of parts may be associated with each component will be charged.

Much-More Racing Co., Ltd.
 127-1, Poong-dong, Ilsan-gu, Goyang-city, Gyeong-gi-do, 410-842 Korea
 Phone +82(31)903-0381 | Fax +82(31)903-0497
 www.muchmore racing.net



Warning Notes

Please read the following instructions carefully before you start using your products.
 Muchmore racing cannot be held responsible for damage, and results of non-observance of the warning notes and security advices.

- Keep the product out of the reach of children under 14 years.
 - Pay attention to the user manual, please take your time in order to understand user guide before using this product.
 - Never leave the product while it is switched on, in use or connected with a power source.
 - Avoid incorrect connection or connection with reversed polarity of the product.
 -In case of a short circuit, it can be happen a fatal damage, please remove all wires and connector form the product.
 - Avoid contact with water, oil or fuels or other electro conductive liquid, which are very harmful for electronic circuits. If this happens, stop the use of your product immediately and dry it enough.
 - Avoid over tightening motor screws. Damaged threads are not covered under warranty.
 - Avoid overloading the motor due to wrong or too long gear ratios. It causes the damage of motor.
 - If motor installs on the car, do not apply full throttle. Due to the high RPM, the motor can get damaged.
 - Always wire up all the parts of the equipment carefully. If any of the connections come loose as a result of vibration, you cannot operate your model. It will occur a no-control situation.
 - Avoid soldering longer than 7 seconds per soldering joint when replace the wire.
 Due to the high power soldering, the motor terminal can get loose their performance..
- * Muchmore racing disclaim all responsibility for defect, property damage, electric shot and severe injuries by misuse.
 * For increasing quality of product, motor specs are subject to change without notice.

Adjust Timing

- First of all loosen the three screws on the back of the motor.
- Turn the timing sensor cover and adjust the position.
- Tighten the three screws well.

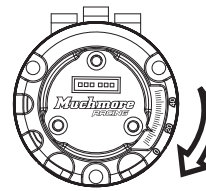

Reduced the timing,
 motor RPM and torque reduce.
 Power consumption gets reduce.

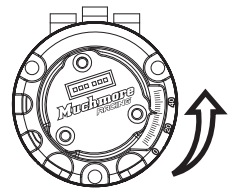

Increase the timing,
 motor RPM and torque increase.
 Power consumption increases.

- Increase the timing, motor temperature is getting higher, battery shorten its running time.
- Adjust motor timing consultation with experts necessarily.
- Timing adjustment requires fine-tuning. Please adjust timing very carefully.

* If your sensor cover screw tighten loosely, due to vibration or some shock, your motor or ESC can get damage. Please sensor cover screw lock tightly.

* If you use spray cleaner, please use R/C cleaner spray products.
 Other product use internal/external parts can cause damages.